



City of Westminster

Licensing Sub-Committee Report

Item No:

Date:

Licensing Ref No:

Title of Report:

Report of:

Wards involved:

Policy context:

Financial summary:

Report Author:

Contact details

24 February 2022

21/12682/LIPV - Premises Licence Variation

Tamarind Restaurant
21 Queen Street
London
W1J 5PR

Director of Public Protection and Licensing

West End

City of Westminster Statement of Licensing Policy

None

Kevin Jackaman
Senior Licensing Officer

Telephone: 020 7641 6500
Email: kjackaman@westminster.gov.uk

1.	Application		
1-A	Applicant and premises		
Application Type:	Variation of a Premises Licence, Licensing Act 2003		
Application received date:	9 November 2021		
Applicant:	Indian Cuisine Limited		
Premises:	Tamarind Restaurant		
Premises address:	21 Queen Street London W1J 5PR	Ward:	West End
		Cumulative Impact Area:	None
		Special Consideration Zone:	None
Premises description:	The premises are a Michelin starred Indian restaurant.		
Variation description:	<p>This variation seeks to:</p> <p>(1) To vary the layout of the premises to include the roof terrace in accordance with the plan submitted with the application.</p> <p>(2) To amend condition 14 of Annex 2 to now read: "The number of persons permitted on the first floor of the premises at any one time (excluding staff) shall not exceed 110 persons"</p>		
Premises licence history:	<p>The premises has had the benefit of a premises licence since at least 2005. The existing premises licence (licence number 21/09273/LIPDPS) is attached as appendix 2 of this report.</p> <p>A full licence history for the premises appears at appendix 3.</p>		
Applicant submissions:	None		
Applicant amendments:	None		

1-B	Current and proposed licensable activities, areas and hours					
Late night refreshment						
Indoors, outdoors or both			Current :		Proposed:	
			Both		No change	
	Current Hours		Proposed Hours		Licensable Area	
	Start:	End:	Start:	End:	Current:	Proposed:
Monday	23:00	00:30	No change		Basement, ground and first floors	No change
Tuesday	23:00	00:30				
Wednesday	23:00	00:30				
Thursday	23:00	00:30				
Friday	23:00	00:30				
Saturday	23:00	00:30				
Sunday	23:00	00:00				
Seasonal variations/ Non-standard timings:		Current:			Proposed:	
		The terminal hour for late night refreshment on New Year's Eve is extended to 05:00 on New Year's Day			No change	

Sale by Retail of Alcohol						
On or off sales			Current :		Proposed:	
			On only		No change	
	Current Hours		Proposed Hours		Licensable Area	
	Start:	End:	Start:	End:	Current:	Proposed:
Monday	10:00	00:00	No change		Basement, ground and first floors	No change
Tuesday	10:0	00:00				
Wednesday	10:0	00:00				
Thursday	10:00	00:00				
Friday	10:00	00:00				
Saturday	10:00	00:00				
Sunday	12:00	23:30				
Seasonal variations/ Non-standard timings:		Current:			Proposed:	
		From the end of permitted hours on New Year's Eve to the start of permitted hours on the following day (or, if there are no permitted hours on the following day, midnight on 31st December).			No change	

Hours premises are open to the public						
	Current Hours		Proposed Hours		Premises Area	
	Start:	End:	Start:	End:	Current:	Proposed:
Monday	10:00	00:30	No change		Basement, ground and first floors	No change
Tuesday	10:00	00:30				
Wednesday	10:00	00:30				
Thursday	10:00	00:30				
Friday	10:00	00:30				
Saturday	10:00	00:30				
Sunday	12:00	00:00				
Seasonal variations/ Non-standard timings:		Current: None			Proposed: No change	

1-C	Layout alteration
The applicant is seeking to vary the layout to include a roof terrace as per the revised plans submitted with the application that appear at Appendix 1 .	

1-D	Conditions being varied
Condition	Proposed variation
14. The number of persons permitted on the first floor of the premises at any one time (Excluding staff) shall not exceed 90 persons.	The number of persons permitted on the first floor of the premises at any one time (excluding staff) shall not exceed 110 persons.
Adult entertainment:	Current position:
	None
	Proposed position:
	No change

2.	Representations
2-A	Responsible Authorities
Responsible Authority:	Environmental Health
Representative:	Anil Drayan
Received:	7 December 2021
Representations are made on Public Nuisance and Public Safety grounds. No additional conditions have been offered for the use of the proposed external area.	
The applicant is requested to contact the undersigned to arrange a site visit after which Environmental Health may propose additional conditions to allay its concerns.	

2-B Other Persons

Name:

[REDACTED]

Address and/or Residents Association:

[REDACTED]
[REDACTED]
[REDACTED]

Received:

23 December 2021

[REDACTED] still object the application for a terrace on the 1st floor,
[REDACTED]

Noise

The proposed works that will be carried out will have a huge noise effect on our business. Being an open-roofed terrace, noise from customers and staff will travel directly upwards into our office. In the five years we have been here we have had non stop building work take place and further works will have a serious impact on our business.

Air conditioning

We have had to have our air conditioning units which are currently sat on the first floor flat roof fixed numerous times due to the fronts having fallen off somehow. How long will it take to move our units to a new base and how long will we be without aircon?

Another factor is we have people who prefer fresh air to aircon and when they are sat in their offices, which are all along the windows we will have no choice to open the windows with diners sat outside. This from a noise perspective but also a confidentiality one.

3.	Policy & Guidance
The following policies within the City Of Westminster Statement of Licensing Policy apply:	
Policy HRS1 applies	<p>A. Applications within the core hours set out below in this policy will generally be granted for the relevant premises uses, subject to not being contrary to other policies in the Statement of Licensing Policy.</p> <p>B. Applications for hours outside the core hours set out in Clause C will be considered on their merits, subject to other relevant policies, and with particular regard to the following:</p> <ol style="list-style-type: none"> 1. The demonstration of compliance in the requirements of policies CD1, PS1, PN1 and CH1 associated with the likelihood of the effect of the grant of a licence for later or earlier hours on crime and disorder, public safety, public nuisance and the protection of children from harm. 2. If the application is located within a Special Consideration Zone they have demonstrated that they have taken account of the issues identified in that area and provided adequate mitigation. 3. Whether there is residential accommodation in the proximity of the premises that would likely be adversely affected by premises being open or carrying out operations at the hours proposed. 4. The proposed hours of the licensable activities and when customers will be permitted to remain on the premises. 5. The proposed hours when any music, including incidental music, will be played. 6. The hours when customers will be allowed to take food or drink outside the premises or be within open areas which form part of the premises. 7. The existing hours of licensable activities and the past operation of the premises (if any) and hours of licensable premises in the vicinity. 8. Whether customers and staff have adequate access to public transport when arriving at and leaving the premises, especially at night. 9. The capacity of the premises. 10. The type of use, recognising that some venues are more likely to impact the licensing objectives than others; for example, pubs and bars are higher risk than theatres, cinemas and other cultural and sporting venues due to the nature of the operation. 11. The Licensing Authority will take into account the active measures proposed for a 'winding down' period including arrangements for people to be collected from the premises to travel home safely. 12. Conditions on hours may be attached that require that the supply of alcohol for consumption on the premises ceases a suitable period of time before customers are required to leave the premises. 13. The council, acting as the Licensing Authority, may reduce hours if, after review, it is necessary to impose conditions specifying shorter hours in order to promote the licensing objectives. 14. Specific days for non-standard hours should be identified and justified as part of the application to allow responsible authorities and interested parties to evaluate the impact that these licensable activities may have, and to plan accordingly. The consideration of applications for later hours for Bank Holiday Mondays will take into account that later hours are generally granted for preceding Sundays and that the next day is a working day. Non-specific days are expected to be covered by Temporary Event Notices or variation

	applications.
Policy RTN1(A) applies	<p>A. Applications outside the West End Cumulative Impact Zone will generally be granted subject to:</p> <ol style="list-style-type: none"> 1. The application meeting the requirements of policies CD1, PS1, PN1 and CH1. 2. The hours for licensable activities being within the council's Core Hours Policy HRS1. 3. The operation of any delivery services for alcohol and/or latenight refreshment meeting the council's Ancillary Delivery of Alcohol and/or Late-Night Refreshment Policy DEL1. 4. The applicant has taken account of the Special Consideration Zones Policy SCZ1 if the premises are located within a designated zone. 5. The application and operation of the venue meeting the definition of a restaurant as per Clause C <p>C. For the purposes of this policy a restaurant is defined as:</p> <ol style="list-style-type: none"> 1. A premises in which customers are shown to their table or the customer will select a table themselves to which food is either served to them or they have collected themselves. 2. Which provide food in the form of substantial table meals that are prepared on the premises and are served and consumed at a table. 3. Which do not provide any takeaway service of food and/or drink for immediate consumption, except if provided via an ancillary delivery service to customers at their residential or workplace address. 4. Where alcohol shall not be sold, supplied, or consumed on the premises otherwise than to persons who are bona fide taking substantial table meals and provided always that the consumption of alcohol by such persons is ancillary to taking such meals. 5. The sale and consumption of alcohol prior to such meals may be in a bar area but must also be ancillary to the taking of such meal.

4. Equality Implications

The Council in its capacity as Licensing Authority has a duty to have regard to its public sector equality duty under section 149 of the Equality Act 2010. In summary, section 149 provides that a Public Authority must, in the exercise of its functions, have due regard to the need to:

- (a) eliminate discrimination harassment, victimisation and any other conduct that is prohibited by or under this Act;
- (b) advance equality of opportunity between persons who share a relevant protected characteristic and persons who do not share it; and
- (c) foster good relations between persons who share a relevant protected characteristics and persons who do not share it.

Section 149 (7) of the Equality Act 2010 defines the relevant protected characteristics as age, disability, gender reassignment, marriage and civil partnership, pregnancy and maternity, race, religion or belief, sex, and sexual orientation.

5.	Appendices
Appendix 1	Premises plans
Appendix 2	Premises Licence 21/09273/LIPDPS
Appendix 3	Premises history
Appendix 4	Proposed conditions
Appendix 5	Residential map and list of premises in the vicinity

Report author:	Kevin Jackaman Senior Licensing Officer
Contact:	Telephone: 0207 641 6500 Email: kjackaman@westminster.gov.uk

If you have any queries about this report or wish to inspect one of the background papers please contact the report author.

Background Documents – Local Government (Access to Information) Act 1972

1	Licensing Act 2003	N/A
2	City of Westminster Statement of Licensing Policy	7 th January 2021
3	Amended Guidance issued under section 182 of the Licensing Act 2003	April 2018
4	Environmental Health representation	7 December 2021
5	Interested Party representation	23 December 2021



Schedule 12
Part A

WARD: West End
UPRN: 010033579487

City of Westminster

64 Victoria Street, London, SW1E 6QP

Premises licence

Regulation 33, 34

Premises licence number:	21/09273/LIPDPS
Original Reference:	05/09048/LIPC

Part 1 – Premises details

Postal address of premises:

Tamarind Restaurant
Basement And Ground Floor South
Meadows House
20 - 22 Queen Street
London
W1J 5PR

Telephone Number: Not Supplied

Where the licence is time limited, the dates:

Not applicable

Licensable activities authorised by the licence:

Late Night Refreshment
Sale by Retail of Alcohol

The times the licence authorises the carrying out of licensable activities:

Late Night Refreshment
Monday to Saturday: 23:00 to 00:30
Sunday: 23:00 to 00:00

Sale by Retail of Alcohol
Monday to Saturday: 10:00 to 00:00
Sunday: 12:00 to 23:30

For times authorised for Christmas, New Year and Good Friday see conditions at Annex 1

The opening hours of the premises:

Monday to Saturday: 10:00 to 00:30
Sunday: 12:00 to 00:00

Where the licence authorises supplies of alcohol, whether these are on and/or off supplies:

Alcohol is supplied for consumption on the Premises.

Part 2

Name, (registered) address, telephone number and email (where relevant) of holder of premises licence:

Indian Cuisine Limited
12 D'Arblay Street
Soho
London
W1F 8DU

Registered number of holder, for example company number, charity number (where applicable)

02917113

Name, address and telephone number of designated premises supervisor where the premises licence authorises the supply of alcohol:

Name: Joy Philip Lopes

Please note: It is the policy of the Licensing Authority not to display the address details of a designated premises supervisor.

Personal licence number and issuing authority of personal licence held by designated premises supervisor where the premises licence authorises for the supply of alcohol:

Licence Number: 223501892
Licensing Authority: London Borough Of Brent

Date: 10 February 2022

This licence has been authorised by Jessica Donovan on behalf of the Director - Public Protection and Licensing.

Annex 1 – Mandatory conditions

1. No supply of alcohol may be made at a time when there is no designated premises supervisor in respect of this licence.
2. No supply of alcohol may be made at a time when the designated premises supervisor does not hold a personal licence or the personal licence is suspended.
3. Every supply of alcohol under this licence must be made or authorised by a person who holds a personal licence.
4.
 - (1) The responsible person must ensure that staff on relevant premises do not carry out, arrange or participate in any irresponsible promotions in relation to the premises.
 - (2) In this paragraph, an irresponsible promotion means any one or more of the following activities, or substantially similar activities, carried on for the purpose of encouraging the sale or supply of alcohol for consumption on the premises—
 - (a) games or other activities which require or encourage, or are designed to require or encourage, individuals to;
 - (i) drink a quantity of alcohol within a time limit (other than to drink alcohol sold or supplied on the premises before the cessation of the period in which the responsible person is authorised to sell or supply alcohol), or
 - (ii) drink as much alcohol as possible (whether within a time limit or otherwise);
 - (b) provision of unlimited or unspecified quantities of alcohol free or for a fixed or discounted fee to the public or to a group defined by a particular characteristic in a manner which carries a significant risk of undermining a licensing objective;
 - (c) provision of free or discounted alcohol or any other thing as a prize to encourage or reward the purchase and consumption of alcohol over a period of 24 hours or less in a manner which carries a significant risk of undermining a licensing objective;
 - (d) selling or supplying alcohol in association with promotional posters or flyers on, or in the vicinity of, the premises which can reasonably be considered to condone, encourage or glamorise anti-social behaviour or to refer to the effects of drunkenness in any favourable manner;
 - (e) dispensing alcohol directly by one person into the mouth of another (other than where that other person is unable to drink without assistance by reason of a disability).
5. The responsible person must ensure that free potable water is provided on request to customers where it is reasonably available.
6.
 - (1) The premises licence holder or club premises certificate holder must ensure that an age verification policy is adopted in respect of the premises in relation to the sale or supply of alcohol.
 - (2) The designated premises supervisor in relation to the premises licence must ensure that the supply of alcohol at the premises is carried on in accordance with the age verification policy.
 - (3) The policy must require individuals who appear to the responsible person to be under 18 years of age (or such older age as may be specified in the policy) to produce on request, before being served alcohol, identification bearing their photograph, date of birth and either—
 - (a) a holographic mark, or
 - (b) an ultraviolet feature.
7. The responsible person must ensure that—

- (a) where any of the following alcoholic drinks is sold or supplied for consumption on the premises (other than alcoholic drinks sold or supplied having been made up in advance ready for sale or supply in a securely closed container) it is available to customers in the following measures—
 - (i) beer or cider: ½ pint;
 - (ii) gin, rum, vodka or whisky: 25 ml or 35 ml; and
 - (iii) still wine in a glass: 125 ml;
- (b) these measures are displayed in a menu, price list or other printed material which is available to customers on the premises; and
- (c) where a customer does not in relation to a sale of alcohol specify the quantity of alcohol to be sold, the customer is made aware that these measures are available.

A responsible person in relation to a licensed premises means the holder of the premise licence in respect of the premises, the designated premises supervisor (if any) or any individual aged 18 or over who is authorised by either the licence holder or designated premises supervisor. For premises with a club premises certificate, any member or officer of the club present on the premises in a capacity that which enables him to prevent the supply of alcohol.

8(i) A relevant person shall ensure that no alcohol is sold or supplied for consumption on or off the premises for a price which is less than the permitted price.

8(ii) For the purposes of the condition set out in paragraph 8(i) above -

- (a) "duty" is to be construed in accordance with the Alcoholic Liquor Duties Act 1979;
- (b) "permitted price" is the price found by applying the formula -

$$P = D + (D \times V)$$

Where -

- (i) P is the permitted price,
 - (ii) D is the amount of duty chargeable in relation to the alcohol as if the duty were charged on the date of the sale or supply of the alcohol, and
 - (iii) V is the rate of value added tax chargeable in relation to the alcohol as if the value added tax were charged on the date of the sale or supply of the alcohol;
- (c) "relevant person" means, in relation to premises in respect of which there is in force a premises licence -
- (i) the holder of the premises licence,
 - (ii) the designated premises supervisor (if any) in respect of such a licence, or
 - (iii) the personal licence holder who makes or authorises a supply of alcohol under such a licence;
- (d) "relevant person" means, in relation to premises in respect of which there is in force a club premises certificate, any member or officer of the club present on the premises in a capacity which enables the member or officer to prevent the supply in question; and
- (e) "value added tax" means value added tax charged in accordance with the Value Added Tax Act 1994.

8(iii). Where the permitted price given by Paragraph 8(ii)(b) above would (apart from this paragraph) not be a whole number of pennies, the price given by that sub-paragraph shall be taken to be the price actually given by that sub-paragraph rounded up to the nearest penny.

8(iv). (1) Sub-paragraph 8(iv)(2) below applies where the permitted price given by Paragraph 8(ii)(b) above on a day ("the first day") would be different from the permitted price on the next day ("the second day") as a result of a change to the rate of duty or value added tax.

- (2) The permitted price which would apply on the first day applies to sales or supplies of alcohol which take place before the expiry of the period of 14 days beginning on the second day.

Conditions reproducing the effect of conditions subject to which the relevant existing licences have effect

Conditions for Sale of Alcohol

9. Intoxicating liquor shall not be sold or supplied on the premises otherwise than to persons taking table meals there and for consumption by such a person as an ancillary to his meal.
10. Suitable beverages other than intoxicating liquor (including drinking water) shall be equally available with or otherwise as an ancillary to meals served in the licensed premises.

Conditions which reproduce the effect of any restriction imposed on the use of the premises by specified enactment

11. Alcohol may be sold or supplied:
- (a) On weekdays, other than Christmas Day, Good Friday or New Year's Eve from 10.00 to 00.00
 - (b) On Sundays, other than Christmas Day or New Year's Eve, and on Good Friday: 12.00 to 23:30
 - (c) On Christmas Day: 12.00 to 22.30
 - (d) On New Year's Eve, except on a Sunday, 10.00 to 23.00
 - (e) On New Year's Eve on a Sunday, 12.00 to 22.30
 - (f) On New Year's Eve from the end of permitted hours on New Year's Eve to the start of permitted hours on the following day (or, if there are no permitted hours on the following day, midnight on 31st December).

The above restrictions do not prohibit:

- (a) during the first twenty minutes after the above hours, the taking of the alcohol from the premises unless the alcohol is supplied or taken in an open vessel;
- (b) during the first thirty minutes after the above hours the consumption of the alcohol on the premises by persons taking table meals there if the alcohol was supplied for consumption as ancillary to the meals;
- (c) the sale or supply of alcohol to or the consumption of alcohol by any person residing in the licensed premises;
- (d) the ordering of alcohol to be consumed off the premises, or the despatch by the vendor of the alcohol so ordered;
- (e) the sale of alcohol to a trader or registered club for the purposes of the trade or club;
- (f) the sale or supply of alcohol to any canteen or mess, being a canteen in which the sale or supply of alcohol is carried out under the authority of the Secretary of State or an authorised mess of members of Her Majesty's naval, military or air forces;
- (g) the taking of alcohol from the premises by a person residing there;
- (h) the supply of alcohol for consumption on the premises to any private friends of a person residing there who are bona fide entertained by him at his own expense, or the consumption of alcohol by persons so supplied;
- (i) the supply of alcohol for consumption on the premises to persons employed there for the purposes of the business carried on by the holder of the licence, or the consumption of liquor so supplied, if the liquor is supplied at the expense of their employer or of the person carrying on or in charge of the business on the premises.

In this condition, any reference to a person residing in the premises shall be construed as including a person not residing there but carrying on or in charge of the business on the premises.

12. Alcohol shall not be sold or supplied unless the premises have been structurally and bona fide used, or intended to be used, for the purposes of habitually providing the customary main meal at midday or in the evening, or both, for the accommodation of persons frequenting the premises

13. The terminal hour for late night refreshment on New Year's Eve is extended to 05:00 on New Year's Day.

Annex 2 – Conditions consistent with the operating Schedule

14. The number of persons permitted on the first floor of the premises at any one time (Excluding staff) shall not exceed 90 persons.
15. Notwithstanding condition 9 alcohol may be supplied consumed prior/post to their meal in the bar area (designated on the plan) by up to a maximum, at any one time of 10 persons, dining at the premises.
16. The premises shall install and maintain a comprehensive CCTV system as per the minimum requirements of the Westminster Police Licensing Team. All entry and exit points will be covered enabling frontal identification of every person entering in any light condition. The CCTV system shall continually record whilst the premises is open for licensable activities and during all times when customers remain on the premises. All recordings shall be stored for a minimum period of 31 days with date and time stamping. Viewing of recordings shall be made available immediately upon the request of Police or authorised officer throughout the entire 31 day period.
17. A staff member from the premises who is conversant with the operation of the CCTV system shall be on the premises at all times when the premises is open. This staff member must be able to provide a Police or authorised council officer copies of recent CCTV images or data with the absolute minimum of delay when requested.
18. An incident log shall be kept at the premises, and made available on request to an authorised officer of the City Council or the Police. It must be completed within 24 hours of the incident and will record the following:
 - (a) all crimes reported to the venue
 - (b) all ejections of patrons
 - (c) any complaints received concerning crime and disorder
 - (d) any incidents of disorder
 - (e) all seizures of drugs or offensive weapons
 - (f) any faults in the CCTV system, searching equipment or scanning equipment
 - (g) any refusal of the sale of alcohol
 - (h) any visit by a relevant authority or emergency service.

Annex 3 – Conditions attached after a hearing by the licensing authority

None

Annex 4 – Plans

LEGEND

- ANY APERTURES IN WALLS, HOOKS OR CEILING THROUGH TO OTHER FLOORS NEED TO BE FIRE STOPPED
- FIRE STOPPING
- FIRE STOPPING
- FIRE STOPPING
- FIRE STOPPING
- FIRE STOPPING
- FIRE STOPPING
- FIRE STOPPING
- FIRE STOPPING
- FIRE STOPPING
- FIRE STOPPING
- FIRE STOPPING
- FIRE STOPPING
- FIRE STOPPING
- FIRE STOPPING
- FIRE STOPPING

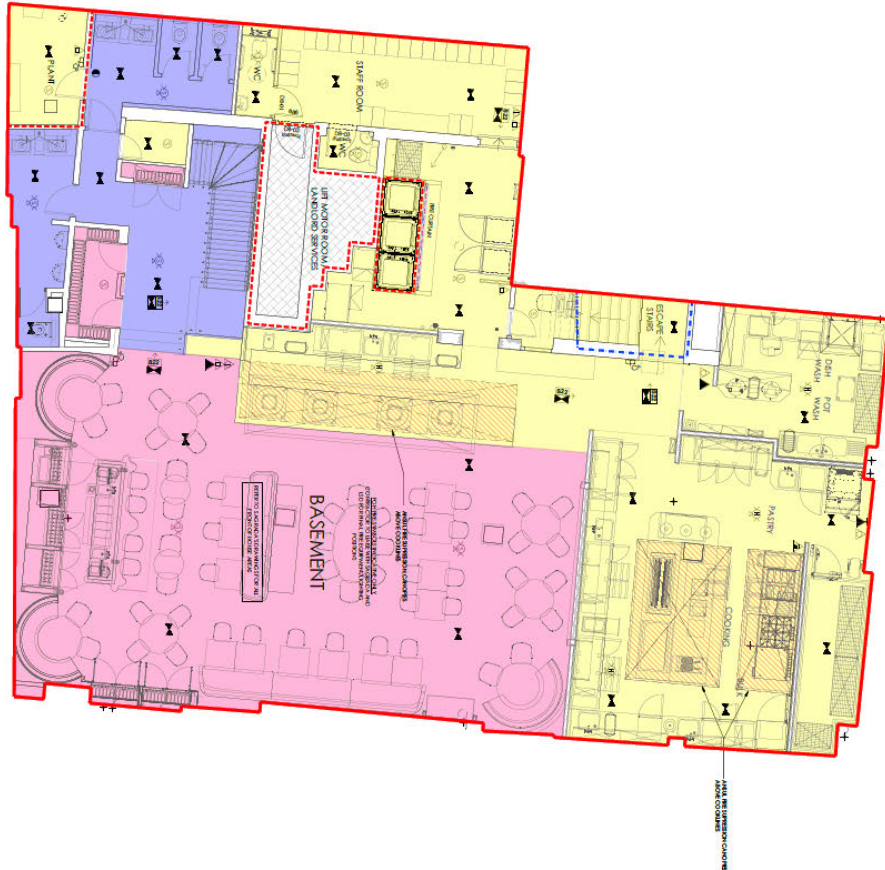

PROPOSED BASEMENT FLOOR FIRE STRATEGY PLAN
SCALE 1:50

ANY APERTURES IN WALLS, HOOKS OR CEILING THROUGH TO OTHER FLOORS NEED TO BE FIRE STOPPED

- FIRE LEGEND:**
- WALL OPENING WITH EMERGENCY LIGHT SIGNIFICATION
 - WALL OPENING WITH EMERGENCY LIGHT SIGNIFICATION
 - WALL OPENING WITH EMERGENCY LIGHT SIGNIFICATION
 - WALL OPENING WITH EMERGENCY LIGHT SIGNIFICATION
 - WALL OPENING WITH EMERGENCY LIGHT SIGNIFICATION
 - WALL OPENING WITH EMERGENCY LIGHT SIGNIFICATION
 - WALL OPENING WITH EMERGENCY LIGHT SIGNIFICATION
 - WALL OPENING WITH EMERGENCY LIGHT SIGNIFICATION
 - WALL OPENING WITH EMERGENCY LIGHT SIGNIFICATION
 - WALL OPENING WITH EMERGENCY LIGHT SIGNIFICATION
 - WALL OPENING WITH EMERGENCY LIGHT SIGNIFICATION
 - WALL OPENING WITH EMERGENCY LIGHT SIGNIFICATION
 - WALL OPENING WITH EMERGENCY LIGHT SIGNIFICATION
 - WALL OPENING WITH EMERGENCY LIGHT SIGNIFICATION
 - WALL OPENING WITH EMERGENCY LIGHT SIGNIFICATION
 - WALL OPENING WITH EMERGENCY LIGHT SIGNIFICATION

NOTES:

1. ALL APERTURES IN WALLS, HOOKS OR CEILING THROUGH TO OTHER FLOORS NEED TO BE FIRE STOPPED
2. ALL APERTURES IN WALLS, HOOKS OR CEILING THROUGH TO OTHER FLOORS NEED TO BE FIRE STOPPED
3. ALL APERTURES IN WALLS, HOOKS OR CEILING THROUGH TO OTHER FLOORS NEED TO BE FIRE STOPPED
4. ALL APERTURES IN WALLS, HOOKS OR CEILING THROUGH TO OTHER FLOORS NEED TO BE FIRE STOPPED
5. ALL APERTURES IN WALLS, HOOKS OR CEILING THROUGH TO OTHER FLOORS NEED TO BE FIRE STOPPED
6. ALL APERTURES IN WALLS, HOOKS OR CEILING THROUGH TO OTHER FLOORS NEED TO BE FIRE STOPPED
7. ALL APERTURES IN WALLS, HOOKS OR CEILING THROUGH TO OTHER FLOORS NEED TO BE FIRE STOPPED
8. ALL APERTURES IN WALLS, HOOKS OR CEILING THROUGH TO OTHER FLOORS NEED TO BE FIRE STOPPED
9. ALL APERTURES IN WALLS, HOOKS OR CEILING THROUGH TO OTHER FLOORS NEED TO BE FIRE STOPPED
10. ALL APERTURES IN WALLS, HOOKS OR CEILING THROUGH TO OTHER FLOORS NEED TO BE FIRE STOPPED
11. ALL APERTURES IN WALLS, HOOKS OR CEILING THROUGH TO OTHER FLOORS NEED TO BE FIRE STOPPED
12. ALL APERTURES IN WALLS, HOOKS OR CEILING THROUGH TO OTHER FLOORS NEED TO BE FIRE STOPPED
13. ALL APERTURES IN WALLS, HOOKS OR CEILING THROUGH TO OTHER FLOORS NEED TO BE FIRE STOPPED
14. ALL APERTURES IN WALLS, HOOKS OR CEILING THROUGH TO OTHER FLOORS NEED TO BE FIRE STOPPED
15. ALL APERTURES IN WALLS, HOOKS OR CEILING THROUGH TO OTHER FLOORS NEED TO BE FIRE STOPPED
16. ALL APERTURES IN WALLS, HOOKS OR CEILING THROUGH TO OTHER FLOORS NEED TO BE FIRE STOPPED
17. ALL APERTURES IN WALLS, HOOKS OR CEILING THROUGH TO OTHER FLOORS NEED TO BE FIRE STOPPED
18. ALL APERTURES IN WALLS, HOOKS OR CEILING THROUGH TO OTHER FLOORS NEED TO BE FIRE STOPPED
19. ALL APERTURES IN WALLS, HOOKS OR CEILING THROUGH TO OTHER FLOORS NEED TO BE FIRE STOPPED
20. ALL APERTURES IN WALLS, HOOKS OR CEILING THROUGH TO OTHER FLOORS NEED TO BE FIRE STOPPED

CLIENT	
INDIAN CHIEFLD LTD	231 THE SPINNAKE
LONDON	W1 1JN
PROJECT	
INDIAN CHIEFLD	231 THE SPINNAKE
LONDON	W1 1JN
THE	
COMMUNITY HUB	231 THE SPINNAKE
LONDON	W1 1JN
DATE	
6219	APR 18
DRAWING	
6219/01	APR 18
130 @ A1	APR 18
SCALE	
1:50	APR 18
PROJECT NO.	
6219	APR 18
PROJECT NAME	
INDIAN CHIEFLD	231 THE SPINNAKE
LONDON	W1 1JN
PROJECT ADDRESS	
INDIAN CHIEFLD	231 THE SPINNAKE
LONDON	W1 1JN
PROJECT CONTACT	
INDIAN CHIEFLD	231 THE SPINNAKE
LONDON	W1 1JN
PROJECT PHONE	
INDIAN CHIEFLD	231 THE SPINNAKE
LONDON	W1 1JN



City of Westminster
64 Victoria Street, London, SW1E 6QP

Schedule 12
Part B

WARD: West End
UPRN: 010033579487

Premises licence
summary

Regulation 33, 34

Premises licence number:

21/09273/LIPDPS

Part 1 – Premises details

Postal address of premises:

Tamarind Restaurant
Basement And Ground Floor South
Meadows House
20 - 22 Queen Street
London
W1J 5PR

Telephone Number: Not Supplied

Where the licence is time limited, the dates:

Not applicable

Licensable activities authorised by the licence:

Late Night Refreshment
Sale by Retail of Alcohol

The times the licence authorises the carrying out of licensable activities:

Late Night Refreshment

Monday to Saturday: 23:00 to 00:30
Sunday: 23:00 to 00:00

Sale by Retail of Alcohol

Monday to Saturday: 10:00 to 00:00
Sunday: 12:00 to 23:30

For times authorised for Christmas, New Year and Good Friday see conditions at Annex 1

The opening hours of the premises:

Monday to Saturday: 10:00 to 00:30
Sunday: 12:00 to 00:00

Where the licence authorises supplies of alcohol, whether these are on and/or off supplies:

Alcohol is supplied for consumption on the Premises.

Name and (registered) address of holder of premises licence:

Indian Cuisine Limited
12 D'Arblay Street
Soho
London
W1F 8DU

Registered number of holder, for example company number, charity number (where applicable)

02917113

Name of designated premises supervisor where the premises licence authorises for the supply of alcohol:

Name: Joy Philip Lopes

State whether access to the premises by children is restricted or prohibited:

Restricted

Date: 10 February 2022

This licence has been authorised by Jessica Donovan on behalf of the Director - Public Protection and Licensing.

Licence & Appeal History

Application	Details of Application	Date Determined	Decision
05/09048/LIPC	Conversion	30.09.2005	Granted under delegated authority
06/01321/LIPDPS	Variation of DPS	28.02.2006	Granted under delegated authority
07/01221/WCCMAP	Master licence	30.09.2005	Granted under delegated authority
16/04026/LIPV	Variation – change of layout	17.06.2016	Granted under delegated authority
17/00308/LIPDPS	Variation of DPS	10.02.2017	Granted under delegated authority
18/08019/LIPV	Variation – Vary the layout and amend conditions	28.08.2018	Granted under delegated authority
18/14168/LIPDPS	Variation of DPS	22.10.2019	Granted under delegated authority
21/09273/LIPDPS	Variation of DPS	09.02.2022	Granted under delegated authority

There is no appeal history

CONDITIONS CONSISTENT WITH THE OPERATING SCHEDULE AND CONDITIONS PROPOSED BY A PARTY TO THE HEARING

When determining an application for a new premises licence under the provisions of the Licensing Act 2003, the licensing authority must, unless it decides to reject the application, grant the licence subject to the conditions which are indicated as mandatory in this schedule.

At a hearing the licensing authority may, in addition, and having regard to any representations received, grant the licence subject to such conditions which are consistent with the operating schedule submitted by the applicant as part of their application, or alter or omit these conditions, or add any new condition to such extent as the licensing authority considers appropriate for the promotion of the licensing objectives.

This schedule lists those conditions which are consistent with the operating schedule, or proposed as appropriate for the promotion of the licensing objectives by a responsible authority or an interested party as indicated. These conditions have not been submitted by the licensing service but reflect the positions of the applicant, responsible authority or interested party and have not necessarily been agreed

Conditions: On Current Licence -

Mandatory:

1. No supply of alcohol may be made at a time when there is no designated premises supervisor in respect of this licence.
2. No supply of alcohol may be made at a time when the designated premises supervisor does not hold a personal licence or the personal licence is suspended.
3. Every supply of alcohol under this licence must be made or authorised by a person who holds a personal licence.
4.
 - (1) The responsible person must ensure that staff on relevant premises do not carry out, arrange or participate in any irresponsible promotions in relation to the premises.
 - (2) In this paragraph, an irresponsible promotion means any one or more of the following activities, or substantially similar activities, carried on for the purpose of encouraging the sale or supply of alcohol for consumption on the premises—
 - (a) games or other activities which require or encourage, or are designed to require or encourage, individuals to;
 - (i) drink a quantity of alcohol within a time limit (other than to drink alcohol sold or supplied on the premises before the cessation of the period in which the responsible person is authorised to sell or supply alcohol), or
 - (ii) drink as much alcohol as possible (whether within a time limit or otherwise);
 - (b) provision of unlimited or unspecified quantities of alcohol free or for a fixed or discounted fee to the public or to a group defined by a particular characteristic in a manner which carries a significant risk of undermining a licensing objective;

- (c) provision of free or discounted alcohol or any other thing as a prize to encourage or reward the purchase and consumption of alcohol over a period of 24 hours or less in a manner which carries a significant risk of undermining a licensing objective;
 - (d) selling or supplying alcohol in association with promotional posters or flyers on, or in the vicinity of, the premises which can reasonably be considered to condone, encourage or glamorise anti-social behaviour or to refer to the effects of drunkenness in any favourable manner;
 - (e) dispensing alcohol directly by one person into the mouth of another (other than where that other person is unable to drink without assistance by reason of a disability).
5. The responsible person must ensure that free potable water is provided on request to customers where it is reasonably available.
6. (1) The premises licence holder or club premises certificate holder must ensure that an age verification policy is adopted in respect of the premises in relation to the sale or supply of alcohol.
- (2) The designated premises supervisor in relation to the premises licence must ensure that the supply of alcohol at the premises is carried on in accordance with the age verification policy.
- (3) The policy must require individuals who appear to the responsible person to be under 18 years of age (or such older age as may be specified in the policy) to produce on request, before being served alcohol, identification bearing their photograph, date of birth and either—
- (a) a holographic mark, or
 - (b) an ultraviolet feature.
7. The responsible person must ensure that—
- (a) where any of the following alcoholic drinks is sold or supplied for consumption on the premises (other than alcoholic drinks sold or supplied having been made up in advance ready for sale or supply in a securely closed container) it is available to customers in the following measures—
 - (i) beer or cider: ½ pint;
 - (ii) gin, rum, vodka or whisky: 25 ml or 35 ml; and
 - (iii) still wine in a glass: 125 ml;
 - (b) these measures are displayed in a menu, price list or other printed material which is available to customers on the premises; and
 - (c) where a customer does not in relation to a sale of alcohol specify the quantity of alcohol to be sold, the customer is made aware that these measures are available.

A responsible person in relation to a licensed premises means the holder of the premise licence in respect of the premises, the designated premises supervisor (if any) or any individual aged 18 or over who is authorised by either the licence holder or designated premises supervisor.

For premises with a club premises certificate, any member or officer of the club present on the premises in a capacity that which enables him to prevent the supply of alcohol.

8(i) A relevant person shall ensure that no alcohol is sold or supplied for consumption on or off the premises for a price which is less than the permitted price.

8(ii) For the purposes of the condition set out in paragraph 8(i) above -

(a) "duty" is to be construed in accordance with the Alcoholic Liquor Duties Act 1979;

(b) "permitted price" is the price found by applying the formula -

$$P = D+(D \times V)$$

Where -

(i) P is the permitted price,

(ii) D is the amount of duty chargeable in relation to the alcohol as if the duty were charged on the date of the sale or supply of the alcohol, and

(iii) V is the rate of value added tax chargeable in relation to the alcohol as if the value added tax were charged on the date of the sale or supply of the alcohol;

(c) "relevant person" means, in relation to premises in respect of which there is in force a premises licence -

(i) the holder of the premises licence,

(ii) the designated premises supervisor (if any) in respect of such a licence, or

(iii) the personal licence holder who makes or authorises a supply of alcohol under such a licence;

(d) "relevant person" means, in relation to premises in respect of which there is in force a club premises certificate, any member or officer of the club present on the premises in a capacity which enables the member or officer to prevent the supply in question; and

(e) "value added tax" means value added tax charged in accordance with the Value Added Tax Act 1994.

8(iii). Where the permitted price given by Paragraph 8(ii)(b) above would (apart from this paragraph) not be a whole number of pennies, the price given by that sub-paragraph shall be taken to be the price actually given by that sub-paragraph rounded up to the nearest penny.

8(iv). (1) Sub-paragraph 8(iv)(2) below applies where the permitted price given by Paragraph 8(ii)(b) above on a day ("the first day") would be different from the permitted price on the next day ("the second day") as a result of a change to the rate of duty or value added tax.

(2) The permitted price which would apply on the first day applies to sales or supplies of alcohol which take place before the expiry of the period of 14 days beginning on the second day.

Conditions reproducing the effect of conditions subject to which the relevant existing licences have effect

Conditions for Sale of Alcohol

9. Intoxicating liquor shall not be sold or supplied on the premises otherwise than to persons taking table meals there and for consumption by such a person as an ancillary to his meal.
10. Suitable beverages other than intoxicating liquor (including drinking water) shall be equally available with or otherwise as an ancillary to meals served in the licensed premises.

Conditions which reproduce the effect of any restriction imposed on the use of the premises by specified enactment

11. Alcohol may be sold or supplied:
 - (a) On weekdays, other than Christmas Day, Good Friday or New Year's Eve from 10.00 to 00.00
 - (b) On Sundays, other than Christmas Day or New Year's Eve, and on Good Friday: 12.00 to 23:30
 - (c) On Christmas Day: 12.00 to 22.30
 - (d) On New Year's Eve, except on a Sunday, 10.00 to 23.00
 - (e) On New Year's Eve on a Sunday, 12.00 to 22.30
 - (f) On New Year's Eve from the end of permitted hours on New Year's Eve to the start of permitted hours on the following day (or, if there are no permitted hours on the following day, midnight on 31st December).

The above restrictions do not prohibit:

- (a) during the first twenty minutes after the above hours, the taking of the alcohol from the premises unless the alcohol is supplied or taken in an open vessel;
- (b) during the first thirty minutes after the above hours the consumption of the alcohol on the premises by persons taking table meals there if the alcohol was supplied for consumption as ancillary to the meals;
- (c) the sale or supply of alcohol to or the consumption of alcohol by any person residing in the licensed premises;
- (d) the ordering of alcohol to be consumed off the premises, or the despatch by the vendor of the alcohol so ordered;
- (e) the sale of alcohol to a trader or registered club for the purposes of the trade or club;
- (f) the sale or supply of alcohol to any canteen or mess, being a canteen in which the sale or supply of alcohol is carried out under the authority of the Secretary of State or an authorised mess of members of Her Majesty's naval, military or air forces;
- (g) the taking of alcohol from the premises by a person residing there;
- (h) the supply of alcohol for consumption on the premises to any private friends of a person residing there who are bona fide entertained by him at his own expense, or the consumption of alcohol by persons so supplied;
- (i) the supply of alcohol for consumption on the premises to persons employed there for the purposes of the business carried on by the holder of the licence, or the consumption of liquor so supplied, if the liquor is supplied at the expense of their employer or of the person carrying on or in charge of the business on the premises.

In this condition, any reference to a person residing in the premises shall be construed as including a person not residing there but carrying on or in charge of the business on the premises.

12. Alcohol shall not be sold or supplied unless the premises have been structurally and bona fide used, or intended to be used, for the purposes of habitually providing the

customary main meal at midday or in the evening, or both, for the accommodation of persons frequenting the premises

13. The terminal hour for late night refreshment on New Year's Eve is extended to 05:00 on New Year's Day.

Annex 2 – Conditions consistent with the operating Schedule

14. The number of persons permitted on the first floor of the premises at any one time (Excluding staff) shall not exceed 90 persons.

The applicant has proposed the following amendment to condition 14:

The number of persons permitted on the first floor of the premises at any one time (excluding staff) shall not exceed 110 persons.

15. Notwithstanding condition 9 alcohol may be supplied consumed prior/post to their meal in the bar area (designated on the plan) by up to a maximum, at any one time of 10 persons, dining at the premises.
16. The premises shall install and maintain a comprehensive CCTV system as per the minimum requirements of the Westminster Police Licensing Team. All entry and exit points will be covered enabling frontal identification of every person entering in any light condition. The CCTV system shall continually record whilst the premises is open for licensable activities and during all times when customers remain on the premises. All recordings shall be stored for a minimum period of 31 days with date and time stamping. Viewing of recordings shall be made available immediately upon the request of Police or authorised officer throughout the entire 31 day period.
17. A staff member from the premises who is conversant with the operation of the CCTV system shall be on the premises at all times when the premises is open. This staff member must be able to provide a Police or authorised council officer copies of recent CCTV images or data with the absolute minimum of delay when requested.
18. An incident log shall be kept at the premises, and made available on request to an authorised officer of the City Council or the Police. It must be completed within 24 hours of the incident and will record the following:
 - (a) all crimes reported to the venue
 - (b) all ejections of patrons
 - (c) any complaints received concerning crime and disorder
 - (d) any incidents of disorder
 - (e) all seizures of drugs or offensive weapons
 - (f) any faults in the CCTV system, searching equipment or scanning equipment
 - (g) any refusal of the sale of alcohol
 - (h) any visit by a relevant authority or emergency service

Annex 3 – Conditions attached after a hearing by the licensing authority

None

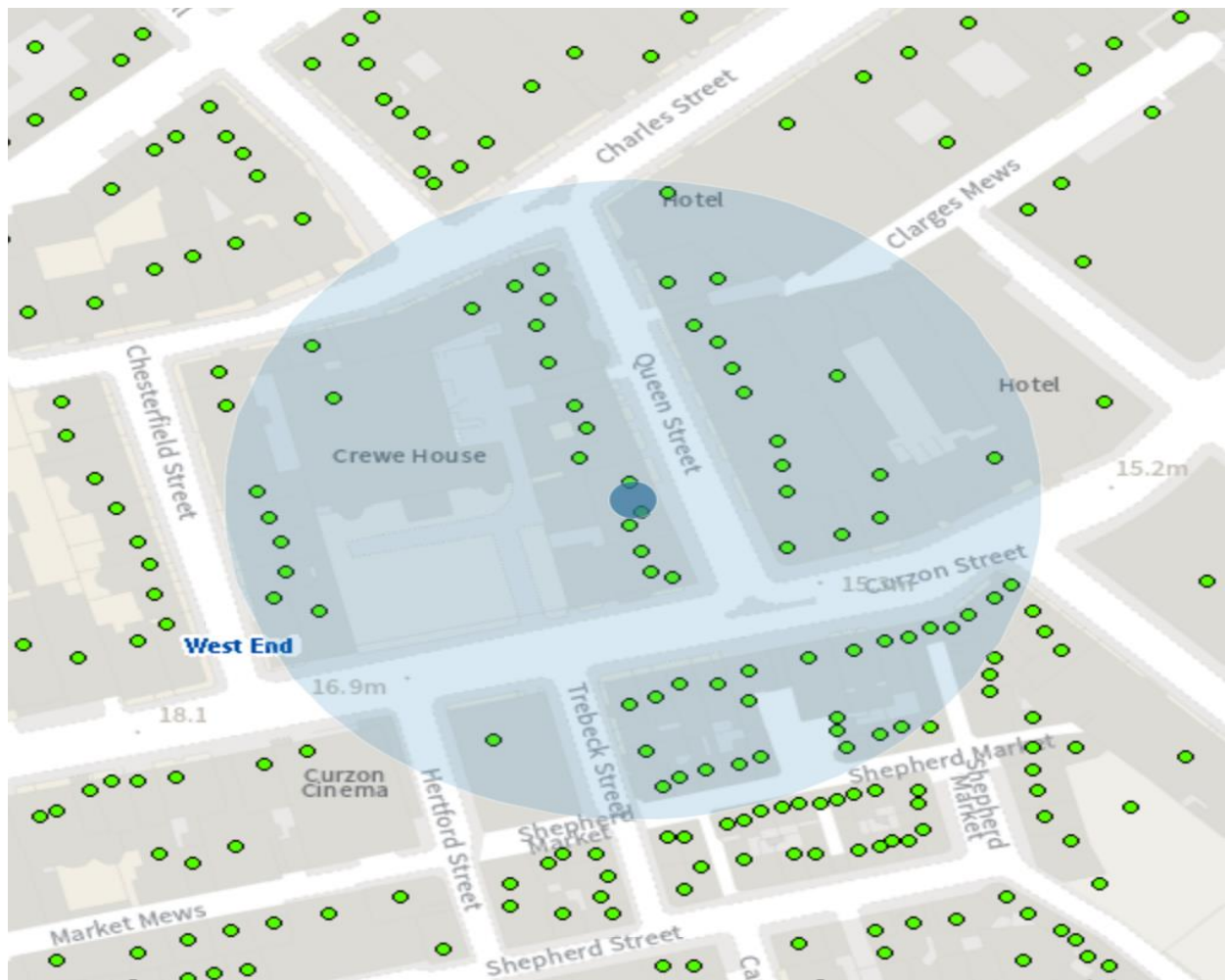

Resident count: 75

Licensed premises within 75m Of Meadows House, 21 Queen Street, London, W1				
Licence Number	Trading Name	Address	Premises Type	Time Period
20/11521/LIPDPS	Murano	Ground Floor North Meadows House 20 - 22 Queen Street London W1J 5PR	Restaurant	Sunday; 12:00 - 00:00 Monday to Saturday; 10:00 - 01:30
19/16561/LIPN	Not Recorded	Basement And Ground Floor 17 Queen Street London W1J 5PH	Not Recorded	Sunday; 10:00 - 23:00 Monday to Saturday; 07:30 - 23:30
20/01581/LIPCH	Little House	2 Queen Street London W1J 5PA	Restaurant	Sunday; 08:00 - 22:30 Monday to Thursday; 08:00 - 01:30

				Friday to Saturday; 08:00 - 02:30
12/08761/LIPN	L'Eto Caffè	Basement And Ground Floor 46 - 48 Shepherd Market London W1J 7QS	Cafe	Monday to Sunday; 08:00 - 20:30
18/14075/LIPT	Curzon Mayfair Cinema	38 Curzon Street London W1J 7TY	Cinema	Sunday; 10:00 - 02:30 Monday to Saturday; 09:00 - 02:30
12/01313/LIPN	Yazu Sushi	Basement Part And Ground Floor 46 Curzon Street London W1J 7UH	Restaurant	Monday to Saturday; 12:00 - 22:00
11/09867/LIPV	Noura	Basement And Ground Floor 16 Curzon Street London W1J 5HP	Restaurant	Saturday; 10:00 - 01:30 Sunday; 12:00 - 00:00 Monday to Friday; 10:00 - 00:30
15/08015/LIPDPS	Brasserie Al Hamra	52 Shepherd Market London W1J 7QU	Cafe	Sunday; 12:00 - 00:30 Monday to Saturday; 09:00 - 00:30
18/13801/LIPT	Private Members Club - Chess Club	Basement To First Floor 1A Chesterfield Street London W1J 5JG	Club or institution	Sunday; 12:00 - 22:30 Monday to Thursday; 10:00 - 23:30 Friday to Saturday; 10:00 - 00:00 Sundays before Bank Holidays; 12:00 - 00:00
18/08882/LIPDPS	Le Boudin Blanc	5 Trebeck Street London W1J 7LT	Restaurant	Sunday; 12:00 - 00:00 Monday to Saturday; 10:00 - 00:30
16/00527/LIPDPS	Chesterfield Hotel	34-36 Charles Street London W1J 5EB	Hotel, 4+ star or major chain	Sunday; 12:00 - 00:00 Monday to Saturday; 10:00 - 00:30
18/07751/LIPDPS	Ferdi	Basement And	Shop	Sunday; 08:00

	Ground Floor 30 Shepherd Market London W1J 7QN		- 23:30 Monday to Saturday; 08:00 - 00:00
--	---	--	--